

# Lockit Bracket

[Buy me](#)

The product is solely and exclusively available for commercial costumers and shall be used by skilled personnel only.

Use the product only for the purpose described in this document. Always follow the valid instructions and system requirements for all equipment involved.

## Description

Bracket for mounting a [AMBIENT NanoLockits](#) or [AMBIENT Lockits](#) with 3/8-16UNC Screw and anti-twist lock ([Arri Pinlock](#)) with retractable pins.

## Usage

### Mounting the Bracket

Position the bracket so that the pins reach into the corresponding holes of the pinlock and screw tight. The use of a 4mm Allen key allows the screw to be “held”, but a slotted screwdriver such as is commonly used for tripod screws (“T-handle”) can also be used.

If there is no Pinlock at the mounting position, the bracket can also be screwed against a closed surface without hesitation, the pins will automatically retract.

When removing the bracket, it is advisable to push it slightly upwards to prevent the UNC screw from being unscrewed from the captive lock.

To replace the screw, simply unscrew it upwards, pressing lightly from below if necessary to make it easier to engage the thread. Make sure that the screw sits straight in the thread; if it is too difficult to turn, do not continue screwing to prevent damage to the thread.



**CAUTION:** Never unscrew the locking plate from the bracket!

## Mounting the Lockits

Position the Lockit outside the two lateral guides and use it to push the collet downwards. Push the Lockit sideways into the holder until the collet engages.

To remove, press the collet down and slide Lockit out sideways. Pay attention to the antenna and/or connected cables, especially with angled plugs.

## NanoLockit

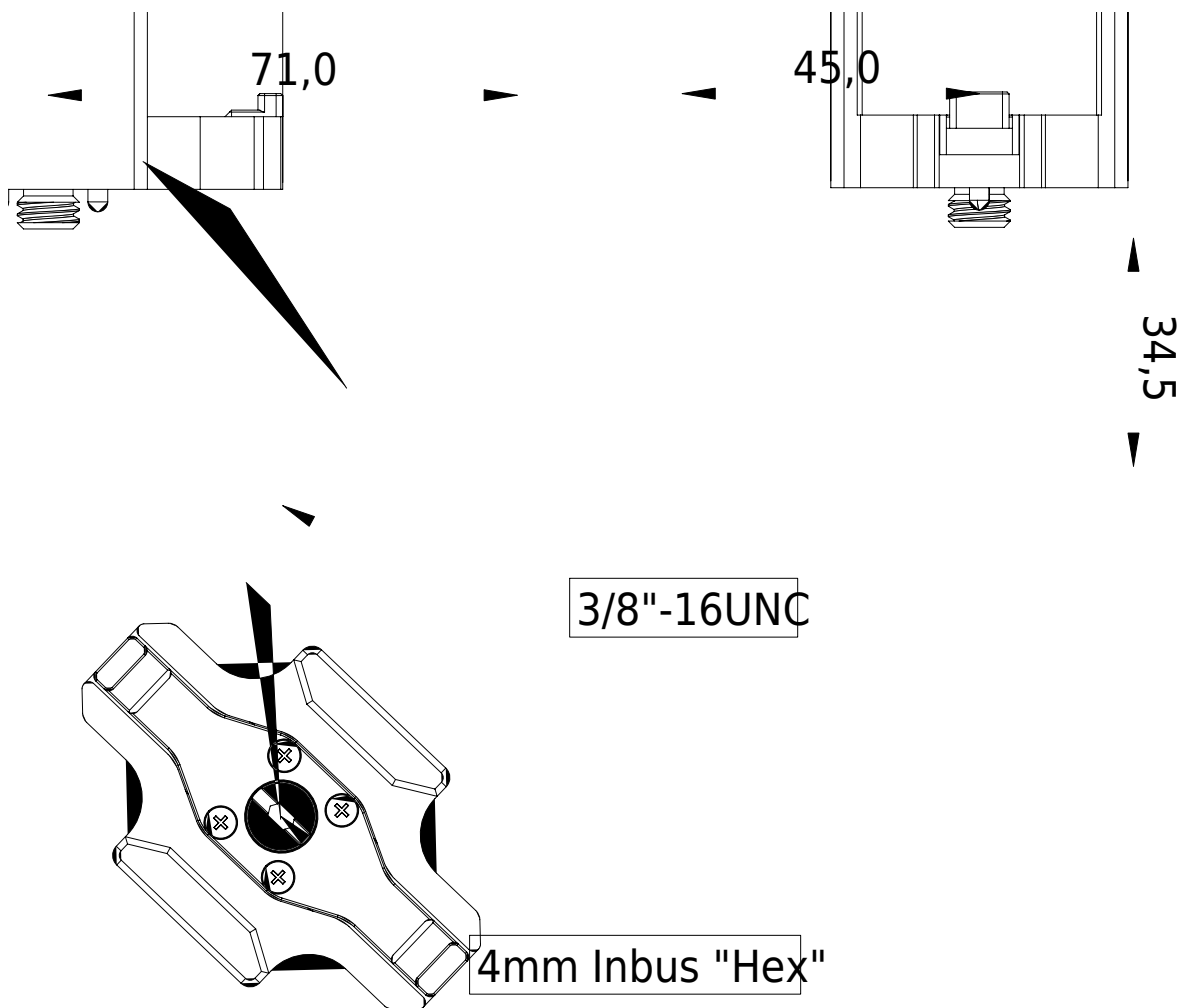

From:  
<https://docs.2eyetec.com/wiki/> - 2EyeTec Manuals

Permanent link:  
<https://docs.2eyetec.com/wiki/en/mechanic/nanolockitbracket?rev=1730478309>

Last update: 2024/11/01 17:25

