

Lockit Bracket

[Buy me](#)

The product is solely and exclusively available for commercial costumers and shall be used by skilled personnel only.

Use the product only for the purpose described in this document. Always follow the valid instructions and system requirements for all equipment involved.

Description

Bracket for mounting a [AMBIENT NanoLockit](#) or [AMBIENT Lockit](#) with 3/8-16UNC Screw and anti-twist lock ([Arri Pinlock](#)) with retractable pins.

Usage

Mounting the Bracket

Position the bracket so that the pins align with the corresponding holes of the pinlock and tighten the screw. The use of a 4mm Allen key allows the screw to be “held”, but a slotted screwdriver, like a common “T-handle” used for tripod screws, is also suitable.

If no pinlock is present at the mounting location, the bracket can be securely screwed onto a closed surface without issue; the pins will automatically retract.

When removing the bracket, it is advisable to push it gently upwards to prevent the UNC screw from being unscrewed from the captive lock.

To replace the screw, simply unscrew it upwards. If needed, apply slight pressure from below to help the thread engage. Ensure that the screw is aligned straight within the thread; if it becomes difficult to turn, stop to avoid damaging the thread.



CAUTION: Never unscrew the locking plate from the bracket!

Mounting the Lockits

Position the Lockit outside the two lateral guides and use it to push the collet downwards. Push the Lockit sideways into the holder until the collet engages.

To remove, press the collet down and slide Lockit out sideways. Pay attention to the antenna and/or connected cables, especially with angled plugs.

NanoLockit Bracket

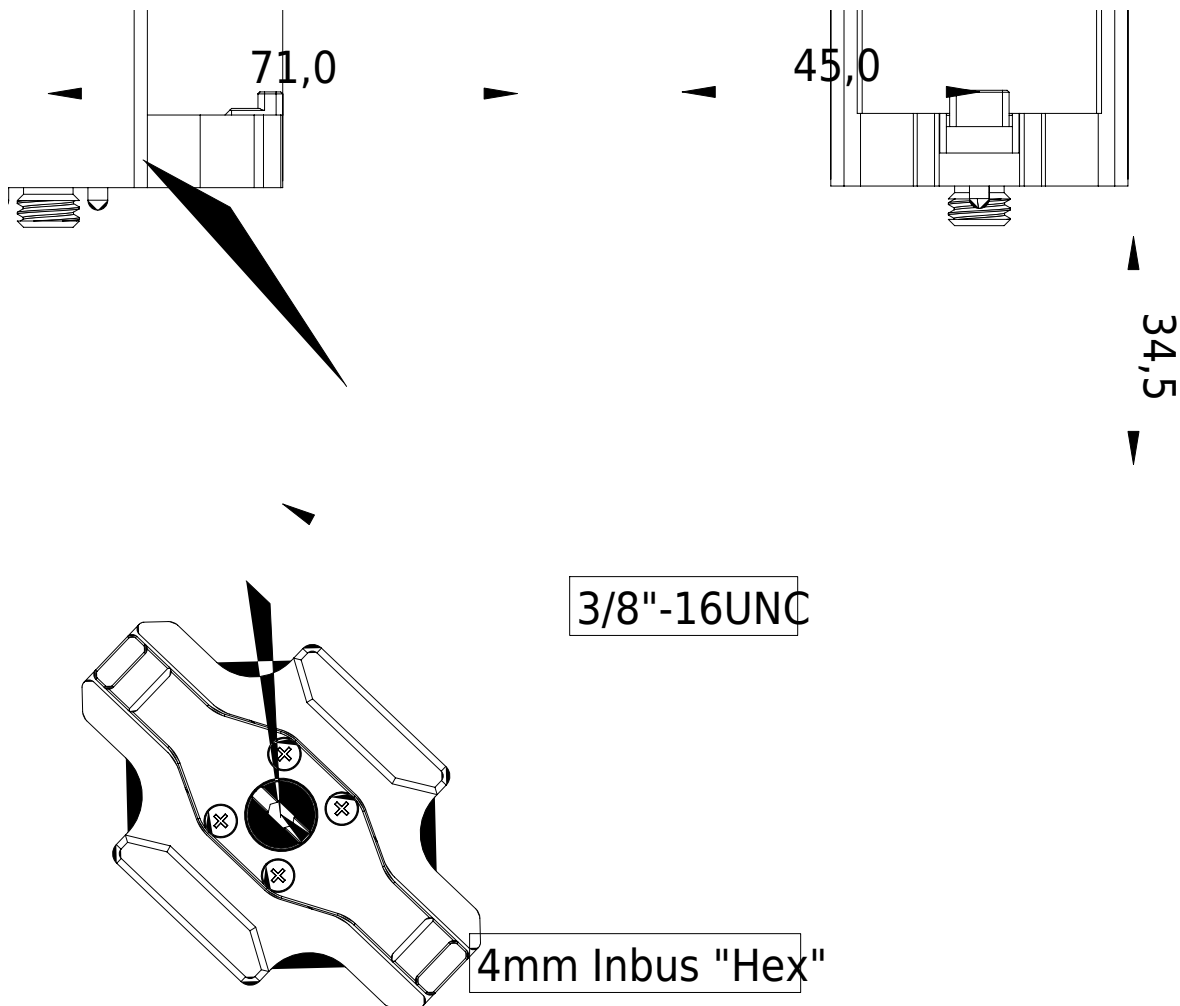

Lockit Bracket

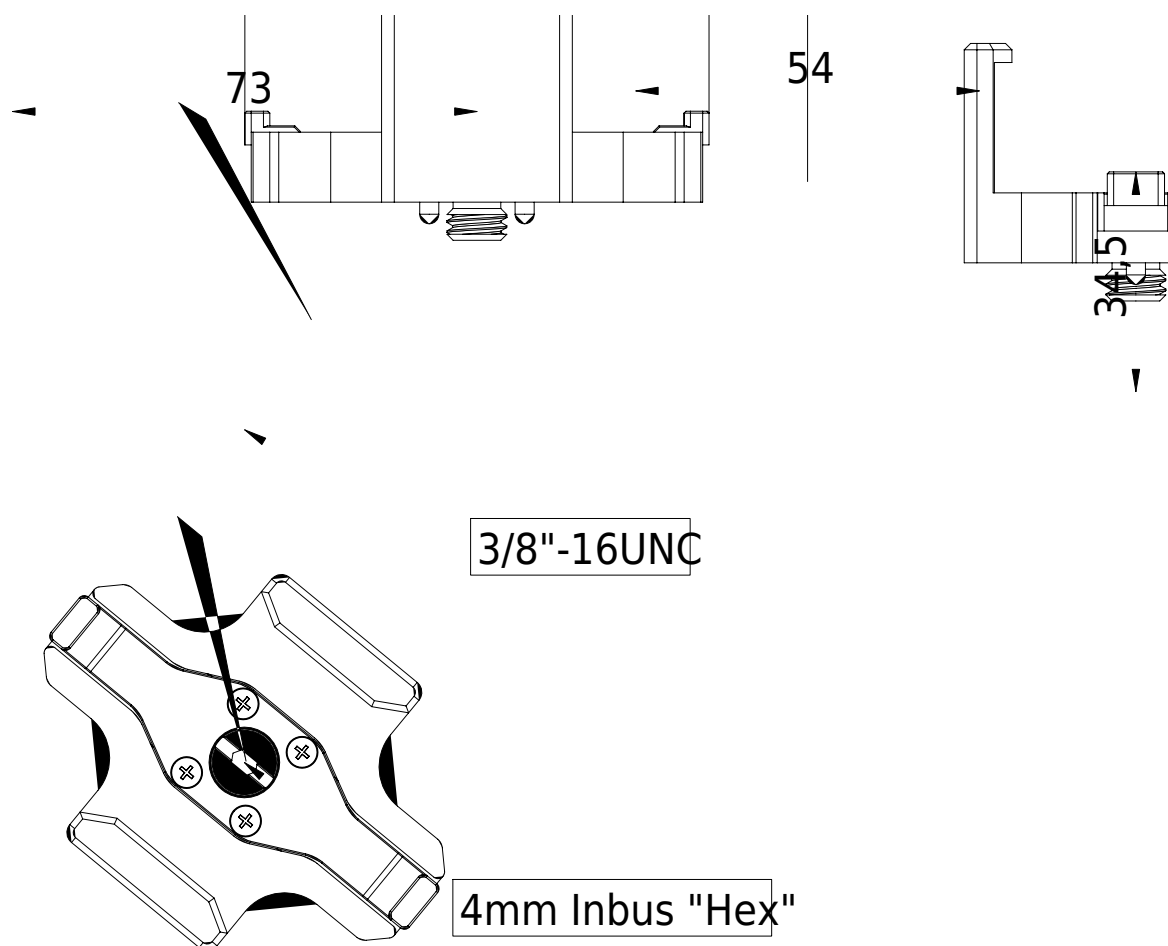

From:

<https://docs.2eyetec.com/wiki/> - **2EyeTec Manuals**

Permanent link:

<https://docs.2eyetec.com/wiki/en/mechanic/nanolockitbracket>

Last update: **2024/11/11 14:11**

